

SalivAIR®

Dental Saliva Ejector

Patented by Anodia Systems, LLC

Item #: MAK-1283

INDICATIONS FOR USE

SalivAIR® is a Dental Saliva Ejector featuring Anodia Systems' exclusive Hygienic & Leverless® Design Comprised of 3 Anodized, Autoclavable Parts: Base, Insert & Shroud. SalivAIR's Smooth Body Contour and Hidden Valve enables an ON / OFF Suction Feature by Sliding the Shroud Up & Down. For Cleaning & Sterilization Purposes, SalivAIR® Assembles & Disassembles within Seconds!



**Saliva Ejector
Suction Tip**
[Removable & Autoclavable]



Assembled SalivAIR

SalivAIR's 3 Parts:



Base Shroud Insert



Suction Cap
Covers Base
when not in use



SalivAIR includes:

1. Suction Cap
 - o Place the Enclosed Suction Cap Over the Saliva Ejector's **Base** Opening when the **Shroud** and **Insert** are being Sterilized while the **Base** is still Connected to Suction Hose.
 - o This Suction Cap Eliminates the Suction Noise.
2. Saliva Ejector Suction Tip (Autoclavable)
 - o Place Saliva Ejector Tip on Top of **Shroud** During Dental Operative Procedures.
3. One Assembled SalivAIR® Saliva Ejector Comprised of 3 Parts: **Base, Shroud & Insert**

DIRECTIONS FOR USE

Suction ON Position:

Turn Suction **ON**
by Sliding
Shroud Away from Base

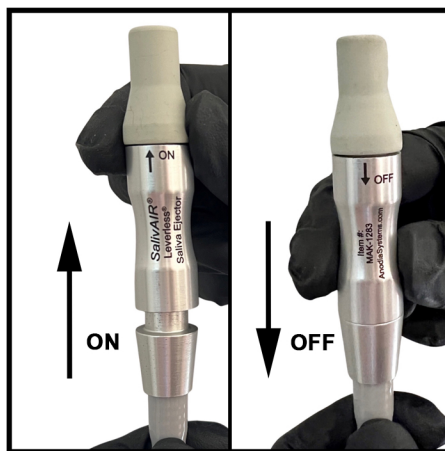

Suction OFF Position:

Turn Suction **OFF**
by Sliding
Shroud & Base together.

ROUTINE CARE

1. After Each Patient, Disconnect SalivAIR's **Shroud** from SalivAIR's **Base**.
2. Leave SalivAIR's **Base** Connected to the Suction Hose Tubing. Place Suction Cap on **Base's** Opening.
3. Take SalivAIR's **2 Parts: Shroud & Insert** to the Sterilization Area. Remove **Insert & Tip** from **Shroud**.
4. Install a Clean, Sterile SalivAIR **Insert, Shroud with Tip** into SalivAIR's **Base**, which is still Connected to the Suction Hose Tubing. Begin Dental Operative Procedures.

IMPORTANT

- After Sterilization, Lubricate the **Insert's 2 O-Rings** and the **Base's 2 O-Rings** with a Lubricant such as Vaseline. Reassemble SalivAIR.
- Steam Autoclave, Dry Heat, Ethylene Oxide, and Gas or Chemical Vapor Process are All Safe to Use, as long as Temperatures Do Not Exceed 280 Degrees Fahrenheit (138 Celsius). **NOTE:** If you use the Chemical Vapor Process, SalivAIR must First be thoroughly Rinsed of All Cleaning Agents. Cleaning Agents left on SalivAIR may React with the Chemical Vapor Solutions to Form a Crystalline Residue, which can Clog SalivAIR or cause it to Stick.

See other side for Assembly & Disassembly

ANODIA®
SYSTEMS
Dental Manufacturer

www.AnodiaSystems.com

ASSEMBLY

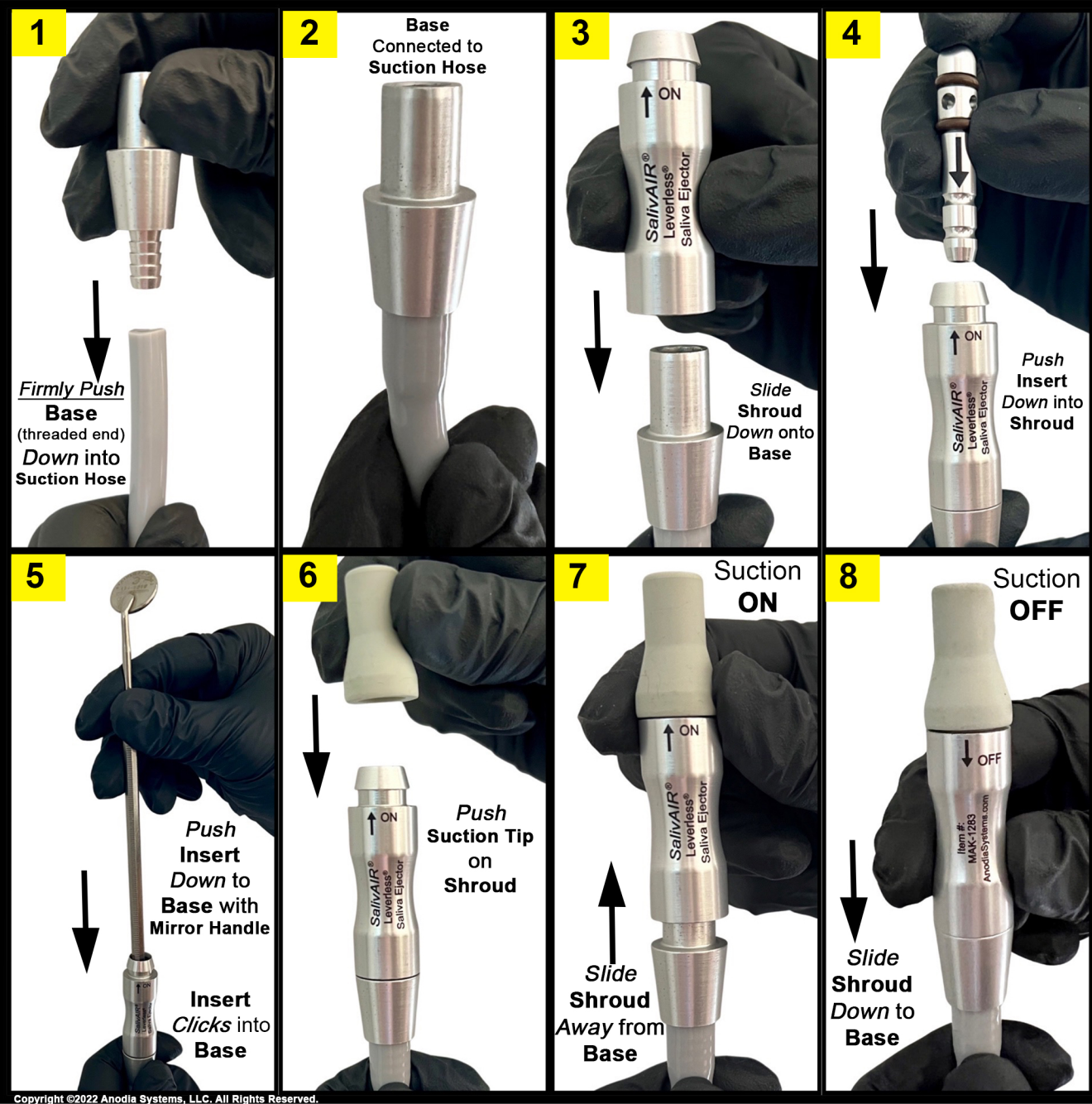

DISASSEMBLY

2 Steps:

